

**vtech**<sup>®</sup>  
Baby

User's Manual

**Toot-Toot  
Drivers**

## Fire Engine Saves The Day



© 2017 VTech  
Printed in China  
All rights reserved  
91-003289-001 (UK)

**VTech understands that a child's needs and abilities change as they grow and with that in mind we develop our toys to teach and entertain at just the right level...**

## **Electronic Learning Computers**

**Cool, aspirational and inspiring computers for curriculum related learning**

## **vtech Baby**

**Toys that will stimulate their interest in different textures, sounds and colours**

### **I am...**

...responding to colours, sounds and textures

...understanding cause and effect

...learning to touch, reach, grasp, sit-up, crawl and toddle

*Birth-36 months*



## **Pre-School**

**Interactive toys to develop their imagination and encourage language development**

### **I want...**

...to get ready for school by starting to learn the alphabet and counting

...my learning to be as fun, easy and exciting as can be

...to show my creativity with drawing and music so my whole brain develops

*3-6 years*



*4-10 years*

### **I need...**

...challenging activities that can keep pace with my growing mind

...intelligent technology that adapts to my level of learning

...National Curriculum based content to support what I'm learning at school



To learn more about this and other VTech® products, visit [www.vtech.co.uk](http://www.vtech.co.uk)

# INTRODUCTION

Thank you for purchasing the **Toot-Toot Drivers® Fire Engine Saves The Day** book by VTech®!

Turn the pages to read and learn with the **Toot-Toot Drivers® Fire Engine Saves The Day** book! Through imitative play your baby will experience the wonderful story of the **Toot-Toot Drivers® Fire Engine**. Fun phrases, songs and realistic sound effects help promote baby's language skills and cognitive abilities.

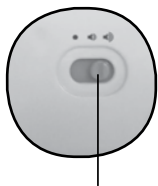

ON/OFF/VOLUME  
CONTROL SWITCH

# INCLUDED IN THIS PACKAGE

- One VTech® Toot-Toot Drivers® Fire Engine Saves The Day
- One user's manual

**WARNING:** All packing materials, such as tape, plastic sheets, packaging locks and tags are not part of this toy, and should be discarded for your child's safety.

**NOTE:** Please keep this instruction manual as it contains important information.

Unlock the packaging locks:

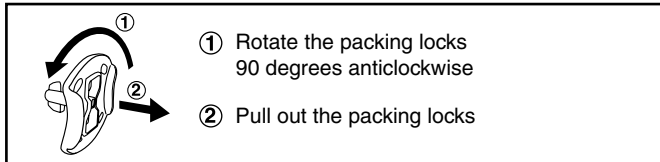

## GETTING STARTED

### BATTERY INSTALLATION

1. Make sure the unit is turned **OFF**.
2. Locate the battery cover on the back of the unit. Use a coin or screwdriver to loosen the screw.
3. Install 2 new AAA (AM-4/LR03) batteries following the diagram inside the battery box. (The use of new alkaline batteries is recommended for maximum performance).
4. Replace the battery cover and tighten the screw to secure.

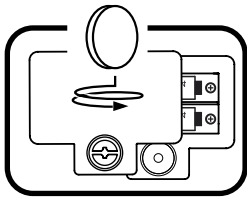

## BATTERY NOTICE

- Use new alkaline batteries for maximum performance.
- Use only batteries of the same or equivalent type as recommended.
- Do not mix different types of batteries: alkaline, standard (carbon-zinc) or rechargeable (Ni-Cd, Ni-MH), or new and used batteries.
- Do not use damaged batteries.
- Insert batteries with the correct polarity.
- Do not short-circuit the battery terminals.
- Remove exhausted batteries from the toy.
- Remove batteries during long periods of non-use.
- Do not dispose of batteries in fire.
- Do not charge non-rechargeable batteries.
- Remove rechargeable batteries from the toy before charging (if removable).
- Rechargeable batteries are only to be charged under adult supervision.

### Disposal of batteries and product



The crossed-out wheellie bin symbols on products and batteries, or on their respective packaging, indicates they must not be disposed of in domestic waste as they contain substances that can be damaging to the environment and human health.



The chemical symbols Hg, Cd or Pb, where marked, indicate that the battery contains more than the specified value of mercury (Hg), cadmium (Cd) or lead (Pb) set out in Battery Directive (2006/66/EC).

The solid bar indicates that the product was placed on the market after 13th August, 2005.

Help protect the environment by disposing of your product or batteries responsibly.

For more information, please visit:

[www.recycle-more.co.uk](http://www.recycle-more.co.uk)

[www.recyclenow.com](http://www.recyclenow.com)

# PRODUCT FEATURES

## 1. ON/OFF/VOLUME CONTROL SWITCH

To turn the unit **ON**, turn the **ON/OFF/VOLUME CONTROL SWITCH** to the **LOW VOLUME** (🔊) or the **HIGH VOLUME** (🔊) position. To turn the unit **OFF**, slide the **ON/OFF/VOLUME CONTROL SWITCH** to the **OFF** (●) position.

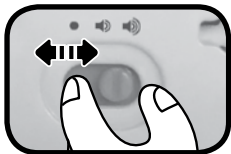

## 2. AUTOMATIC SHUT OFF

To preserve battery life, **VTech® Toot-Toot Drivers® Fire Engine Saves The Day** will automatically shut down after approximately 60 seconds without input. The unit can be turned on again by pressing any button or by turning the pages.

**NOTE:** If the unit powers down while playing, we suggest changing the batteries.

# ACTIVITIES

1. Slide the **ON/OFF/VOLUME CONTROL SWITCH** to turn the unit **ON**. You will hear a playful song, a fun phrase and sounds. The light will flash with the sounds.

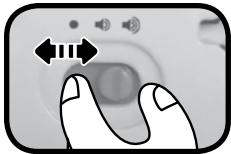

2. Turn the **BOOK PAGES** to hear fun phrases, sounds and short tunes. The light will flash with the sounds.



3. Press the **LIGHT UP BUTTON** to hear playful sing-along songs, fun phrases and sounds. The light will flash with the sounds.

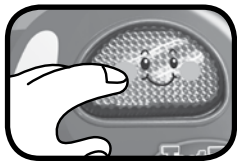

4. Press the **MUSIC BUTTON** to hear fun short tunes when the book is closed and to hear playful melodies when the book is open. When a melody is playing, press the **LIGHT UP BUTTON** to play fun sounds and phrases on top of the melody. The light will flash with the sounds.



## MELODY LIST

1. Three Blind Mice
2. This Old Man
3. Hey Diddle, Diddle
4. Yankee Doodle
5. Shoo Fly Don't Bother Me
6. Row your Boat
7. Pat a Cake
8. Old MacDonald
9. My Bonnie
10. Hot Cross Buns
11. Bingo
12. Camptown Races
13. Animal Fair
14. London Bridge
15. Bill Bailey

## **SING-ALONG SONG LYRICS**

### **SONG 1**

Hurry, Hurry!  
I'll answer the call.  
Time to save one and all.

### **SONG 2**

Raise the ladder higher and higher,  
To rescue people from the fire.

### **SONG 3**

Rescuing is what I do.  
I smile, I cheer and prepare for the next one!

### **SONG 4**

I'm ready, day and night,  
waiting to help, waiting for a fire to fight.

## **CARE & MAINTENANCE**

1. Keep the unit clean by wiping it with a slightly damp cloth.
2. Keep the unit out of direct sunlight and away from any direct heat source.
3. Remove the batteries when the unit is not in use for an extended period of time.
4. Do not drop the unit on hard surfaces and do not expose the unit to moisture or water.



# TROUBLESHOOTING

If for some reason the unit stops working or malfunctions, please follow these steps:

1. Please turn the unit **OFF**.
  2. Interrupt the power supply by removing the batteries.
  3. Let the unit stand for a few minutes, then replace the batteries.
  4. Turn the unit **ON**. The unit should now be ready to play again.
  5. If the product still does not work, replace with a new set of batteries.
- If the problem persists, please call our Consumer Services Department at 01235 546810 (from UK) or +44 1235 546810 (outside UK) and a service representative will be happy to help you.

## **IMPORTANT NOTE:**

Creating and developing **VTech®** products is accompanied by a responsibility that we at **VTech®** take very seriously. We make every effort to ensure the accuracy of the information, which forms the value of our products. However, errors sometimes can occur. It is important for you to know that we stand behind our products and encourage you to call our Consumer Services Department on 01235 546810 (from UK) or +44 1235 546810 (outside UK), with any problems and/or suggestions that you might have. A service representative will be happy to help you.

**CLASS 1  
LED PRODUCT**



# PRODUCT REGISTRATION

Visit [www.vtech.co.uk/clubvtech/login](http://www.vtech.co.uk/clubvtech/login)  
to register your VTech product

By joining the VTech Club you can also enter competitions, find out about news and events, seek expert advice for parents and let your kids play fun learning games and activities.



## PRODUCT WARRANTY

Thank you for choosing this quality product from VTech. We hope it will bring many hours of entertainment, imaginative play and learning.

1. The product detailed above is covered by a one year warranty from the date of purchase, against any defects in materials or workmanship.
2. The product may be returned to the place of purchase. Alternatively the product can be returned to VTech Electronics Europe plc (see address below), with proof of purchase, without proof of purchase no replacement will be provided.
3. VTech Electronics Europe plc will examine the product and if it is found to be defective due to faulty materials or workmanship, will replace the product at their discretion.
4. If the product covered by this warranty is damaged due to misuse, modification or unauthorised repair, or because of faulty batteries, battery discharge or incorrect electrical connections, then this warranty becomes void.
5. This warranty is personal to the original purchaser and is not transferable.
6. Breakages to the LCD screen are not covered by the warranty.
7. Returns to VTech Electronics Europe plc should include a cheque or postal order for £1.50 towards the cost of return postage and packaging.
8. Products returned to VTech Electronics Europe plc, should be addressed as follows and packed carefully to avoid damage in transit (Please do not include batteries or adaptor). Please include details of the fault together with your name and address.
9. To keep an online record of your warranty, please register your product online at [www.vtech.co.uk/warranty](http://www.vtech.co.uk/warranty)

Vtech Electronics EU PLC, c/o XPO Logistics, Warehouse 350, Cat & Fiddle Lane, West Hallam, DE7 6HE

THIS WARRANTY IS OFFERED AS AN EXTRA BENEFIT AND DOES NOT AFFECT CONSUMERS' STATUTORY RIGHTS.

This warranty is valid for the UK and Eire only. For products purchased outside the UK and Eire, please contact your local distributor or place of purchase.

